

SEAT COVERS UNLIMITED
SADDLE BLANKET TRUCK/CAR COVER

INSTALLATION INSTRUCTIONS

Your Saddle blanket may be installed with the seat in or out of your vehicle.

***WARNING: DO NOT CUT BLANKET UNLESS THERE HAS BEEN A PATCH PUT AT THE PROPER LOCATION, THEN DO NOT CUT PAST STITCHING AS EITHER OF THESE WILL VOID YOUR WARRANTY!**

1. Lay the cover out upside down and tie a string to each of the loops located in the center. Then position the cover over the seat cushion with the vinyl/velvet strip in the center and pockets in front.
2. Pull the tie strings through from behind; pull seat belts through openings provided, then position the top part of the seat cover over the backrest. Make sure that the top corners fit on each side.
3. Locate the loops at the top of the backrest. Tie the strings from the center up to the loops located at the top of the seat cover starting in the middle and working out. Attach the string using the double loop knot (as illustrated) and pull snug, but do not tie. Straighten and smooth the cover on the backrest and make sure the pocket in front is in the correct position. Then you can complete the knots at the top of the seat.
4. Tie a string to each of the loops located at the Front of the cover under the pocket and secure each of these tightly under the seat starting in the center and working out, checking the seat as you go.
5. CAUTION: Keep the lacing clear of the seat adjustment mechanisms.
6. To tie the sides of the backrest, attach string to the loops located on the side of the seat cover and attach to other strings or loops. Be sure to check the seat cover before making your final knot.
7. Headrests: On trucks/cars equipped with post style headrests, it will be necessary to remove headrests before installing the headrest by carefully separating the weave, then pushing the headrest post through the seat cover. Be very careful you do not cut the blanket!

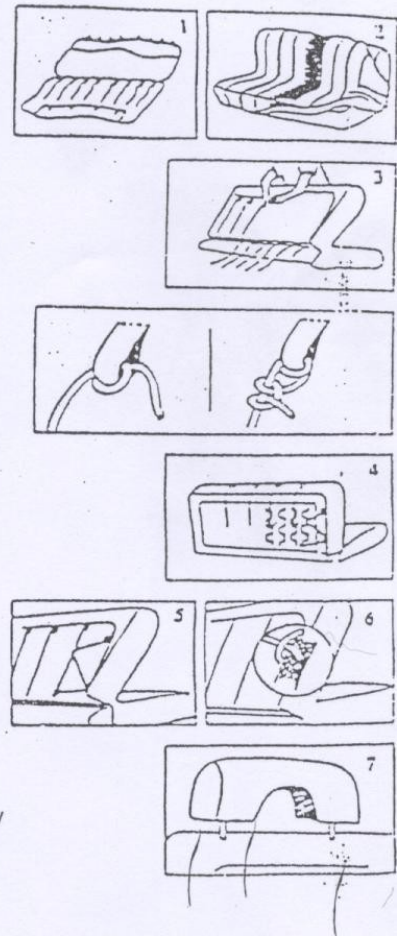

*Occasionally, to make the fit just right, it may be necessary to tie the cover where there isn't a loop provided. In that case, a lace may be tied through the material by spreading the weave as shown. **DO NOT CUT THE BLANKET!**